

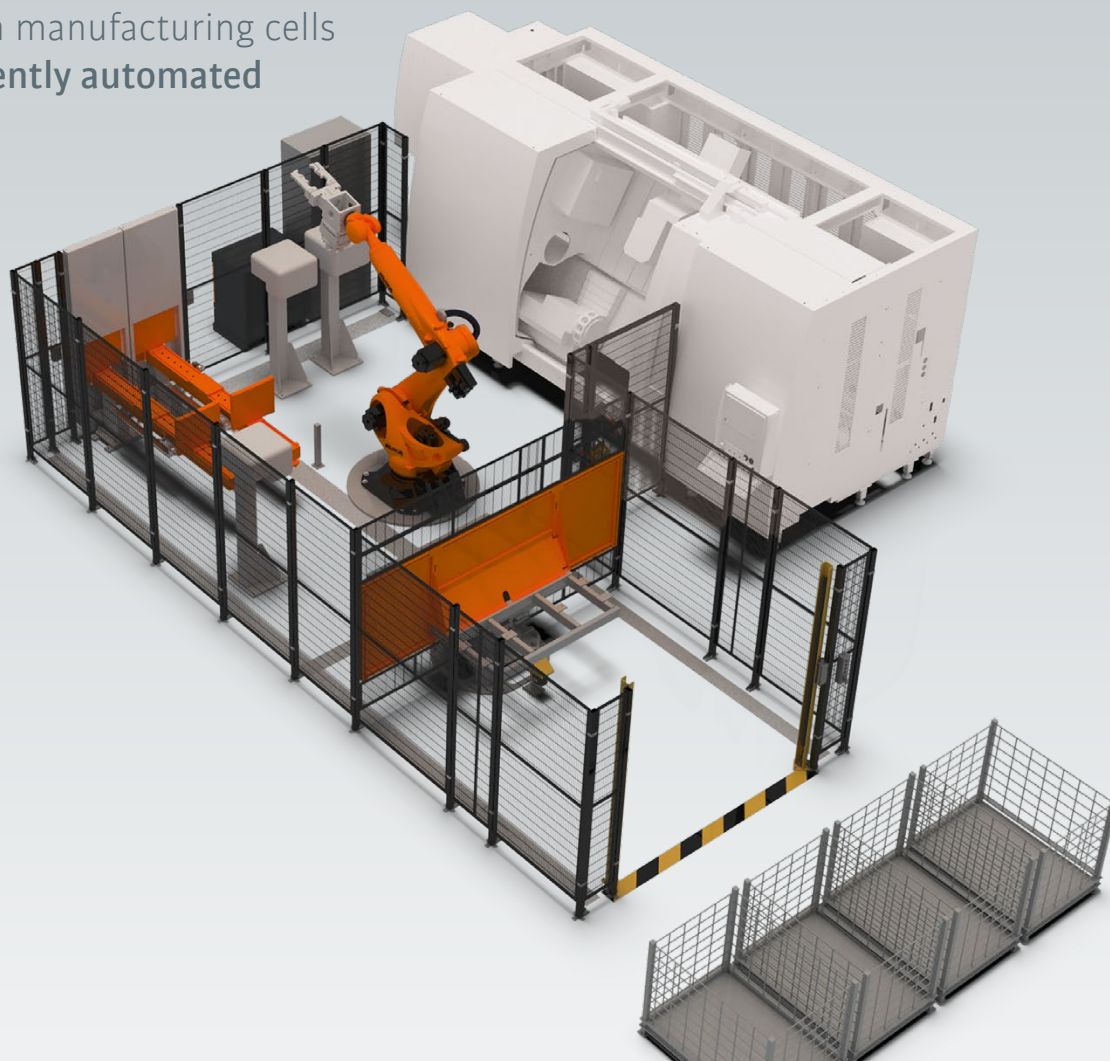

cell4\_production manufacturing cells  
\_handling efficiently automated



## KUKA cell4\_loading modular \_the compact industrial automation solution for handling

KUKA loading and unloading cells are quickly available and can be configured very easily to your specific requirements. Thanks to a wide range of hardware and software options, they can optionally be used to tend CNC machines, friction welders, measuring machines or die-casting machines. KUKA cell4\_loading modular is thus predestined for companies in the Automotive, Tier 1 and General Industry sectors.

### Highlights cell4\_loading modular

- Compact, portable cell on a base frame
- Broad application spectrum with many preconfigured variants
- Optimized for maximum output
- Assured quality with integrated monitoring of process parameters
- Access to KUKA Xpert – the digital knowledge database for all KUKA products

**KUKA** | Xpert

- Ready for IIoT and remote services



KUKA cloud applications

# KUKA cell4\_loading modular

\_modular, flexible loading and unloading cell that can be freely customized

With cell4\_loading modular, KUKA delivers everything from a single source: perfectly coordinated components, defined interfaces and tried-and-tested processes. Preconfigured for immediate commissioning in your individual production environment. The fully-automated cell provides an extremely fast and cost-effective solution for the loading and unloading of machine tools.

**Optimally integrated with comprehensive support from our experts throughout – from planning through to servicing.**

## Service

- Increased productivity and minimized downtime
  - 24/7 hotline
  - Global spare parts and service support
  - Remote Service
  - Service agreements and maintenance
  - Role-specific training courses
- Services for maintaining optimal performance throughout the entire life cycle of the machine

## Planning

- KUKA supports you in the planning phase
- Fast feasibility studies with KUKA.Sim
- Flexible financing models
- Short delivery times
- Modular structure enables adaptation to your production requirements

## Operation

- High system availability thanks to the use of service-proven components
- Future-oriented KUKA.Web HMI for clear visualization and operator control
- Web access to operating data with freely configurable dashboards
- Quality assurance by means of flexible process data monitoring and component-specific documentation

## Integration and commissioning

- Short installation times at the customer's site
- Simple integration of fixtures and other system components
- Simple programming with KUKA technology packages and ready2\_pilot
- Offline programming with KUKA.Sim

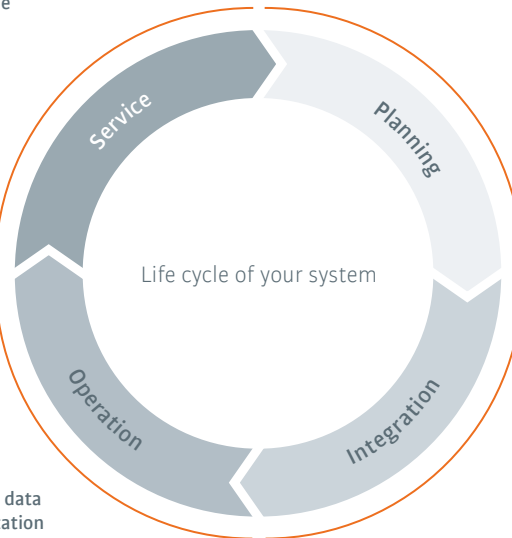

## Standard configuration

cell4\_loading modular KP1A single KR

cell4\_loading modular KP1A single KR

Length	8,200 mm	7,200 mm
Width	5,000 mm	5,000 mm
Height	3,420 mm	3,420 mm
Robot	KR QUANTEC (KR 210 R3100)	KR QUANTEC (KR 210 R3100)
Positioner / payload per side	KP1-MB2000 / 750 kg	KP1-MB2000 / 750 kg
Positioner / usable area per side	KP1-MB 2000 / 2,000 mm x 800 mm	KP1-MB 2000 / 2,000 mm x 800 mm
Drawers / payload	2 for NOK and SPC parts / 200 kg	2 for NOK and SPC parts / 200 kg
Drawers / usable area (W x D)	2 for NOK and SPC parts / 1,400 mm x 500 mm	2 for NOK and SPC parts / 1,400 mm x 500 mm
Cell controller	Siemens S7 Serie 1500	Siemens S7 Serie 1500
Loading area	Light barrier with point-of-operation guarding	Light barrier with point-of-operation guarding

Various option packages can be selected, depending on the specific requirements on the CNC machine automation:

- Reading DMC (camera)
- Writing DMC (needles, scribe marking)
- Reading/writing DMC (laser)
- Advanced KUKA application software packages:
  - KUKA.ProcessScreen (on request)
  - (for monitoring and documentation of process parameters)
- Operator control and visualization with KUKA Advanced HMI (on request)
- Customer-specific designs on request

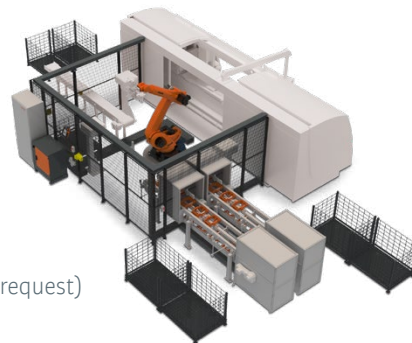

[www.kuka.com/contacts](http://www.kuka.com/contacts)

Details provided about the properties and usability of the products are purely for information purposes and do not constitute a guarantee of these characteristics. The extent of goods delivered is determined by the subject matter of the specific contract. No liability accepted for errors or omissions. Subject to technical alterations. © 2020 KUKA